

# SMT 9070C TS 15

## Thru Beam

Photoelectric Sensors

### Compatible Receivers:

SMR 9070 TS 15

SMR 9170 TS 15

SMR 9270 TS 15

SMR 9370 TS 15

SMR 9471 TS 15

SMR 9472 TS 15

SMR 9473 TS 15

SMR 9474 TS 15



Product Data	
Function	Transmitter
Operation Mode	Thru Beam
Supply Voltage	10 - 30 V dc
Control Feature	Adjustable range and test input
Connection	15 m cable
Sensing Range	70 m
Light Source	Infrared (880 nm)
Housing Material	Stainless Steel
Housing	M18 x 1

Technical Data	
Supply Voltage	10 - 30 V dc
Voltage Ripple	15 %
Reverse Polarity Protected	Yes
Current Consumption	40 mA
Test Input	Yes
Control Input	Adjustable range
Power On Indicator	Green LED
Light Source	Infrared (880 nm)
Emission Angle	+/- 4°
Housing Material, Front Lens	Polycarbonate
Housing Material, Sensor Housing	Stainless Steel (AISI 316 / 1.4401)
Cable	5 x 0,14 mm <sup>2</sup>
Cable Sleeve	PVC Ø 4,9 mm
Channel N°	Selectable 4 channels

**Environmental Data**

Vibration	10 - 55 Hz, 0,5 mm
Shock	30 g
Operation Temperature	-20 to +60 °C
Storage Temperature	-40 to +80 °C
Sealing Class	IP 69K

**Approvals**



**Wiring Diagram**

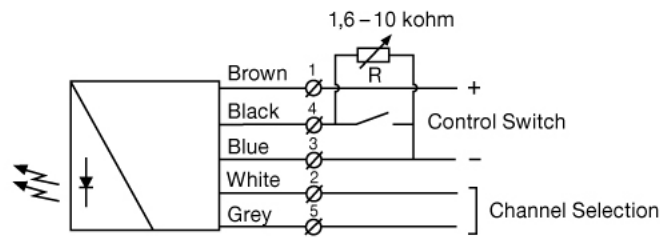

**Parallel Displacement**

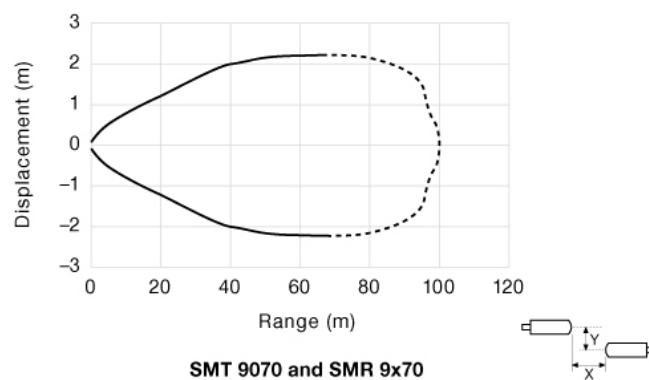

Angular Displacement

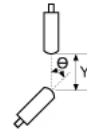
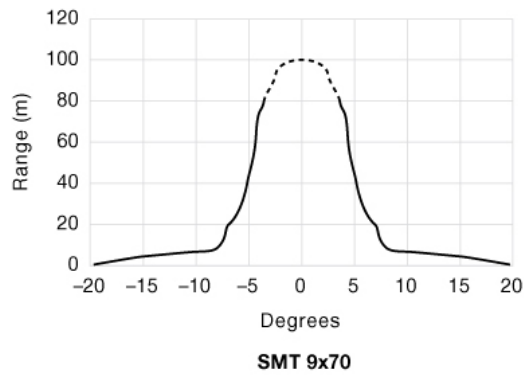

Dimensions

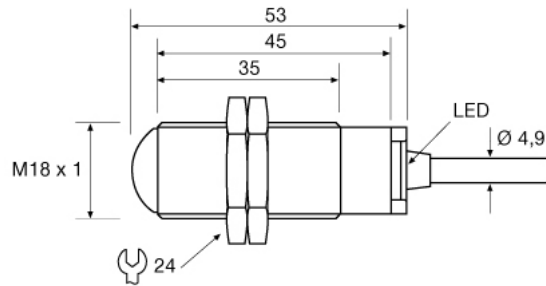

Excess Gain

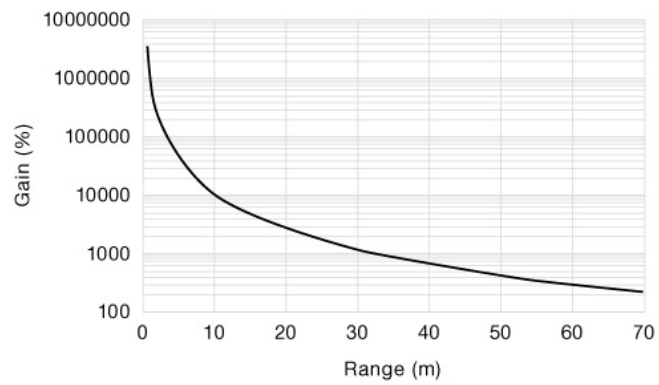

SMT 9070 and SMR 9x7x