

SMR 9270 TP 15

Thru Beam

Photoelectric Sensors

Compatible Transmitter:

SMT 9070C TP 15



Product Data	
Function	Receiver
Operation Mode	Thru Beam
Supply Voltage	10 - 30 V dc
Connection	15 m cable
Sensing Range	70 m
Output	PNP
Output Status	N.C.
Housing Material	Plastic
Housing	M18 x 1

Technical Data	
Supply Voltage	10 - 30 V dc
Voltage Ripple	15 %
Reverse Polarity Protected	Yes
Short Circuit Protected	Yes
Current Consumption	40 mA
Max. Output Load	100 mA
Max. Residual Voltage	2,5 V
Max. Operation Frequency	20 Hz
Response Time ton / toff	25 ms / 25 ms
Output Indicator	Yellow LED
Hysteresis	Approx. 20 %
Opening Angle	+/- 3°
Housing Material, Front Lens	Polycarbonate
Housing Material, Sensor Housing	Polycarbonate
Cable	5 x 0,14 mm²
Cable Sleeve	PVC Ø 4,9 mm
Channel N°	Selectable 4 channels

Environmental Data	
Vibration	10 - 55 Hz, 0,5 mm
Shock	30 g
Operation Temperature	-20 to +60 °C
Storage Temperature	-40 to +80 °C
Sealing Class	IP 69K
Light Immunity 5°	> 20 000 lux
Light Immunity 20°	> 100 000 lux

Approvals



Wiring Diagram

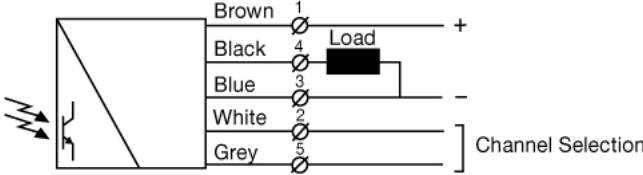

Parallel Displacement

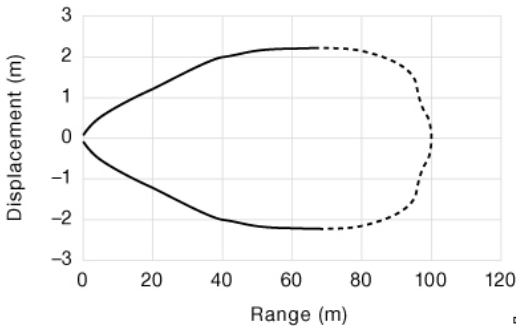

Displacement (m)

Range (m)

SMT 9070 and SMR 9x70

Angular Displacement

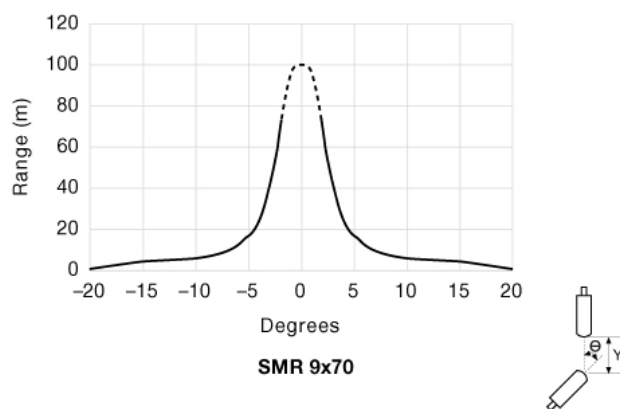

Dimensions

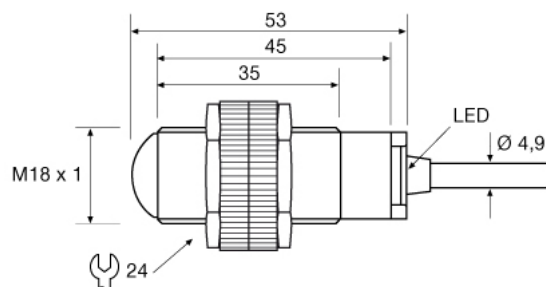

Excess Gain

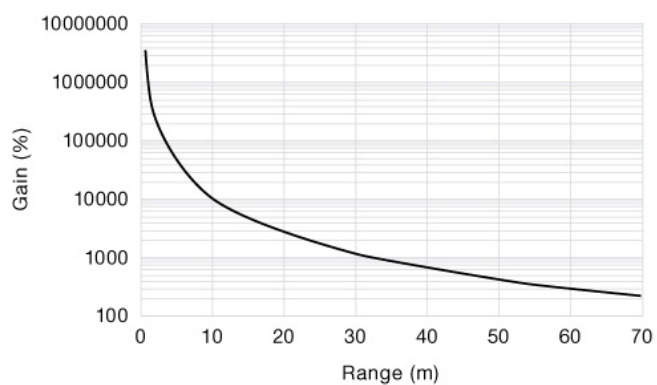

SMT 9070 and SMR 9x7x